



CONSERVATORIUM

AMSTERDAM

We look forward to welcoming you back!

Conservatorium's event spaces are located in the pulsing centre of our historic building, in our landmark lobby, that floods with natural light through the floor to ceiling windows. The hotel offers a total of 329 sqm of event space split over six different rooms on three floors. Every space with a unique design and state-of-the-art high definition technology. The Conservatorium is an inspired choice for any event in the centre of Amsterdam.

When you are ready to meet again, this is our commitment to you:

Over the past months we have missed each and every one of you and, as we prepare for the world to open up, we have been working hard to ensure that you feel safe in returning to our modern grand hotel. In order to safeguard the wellbeing of our guests and employees, we have raised our standards even further to meet the health and safety challenges presented by COVID-19. The meeting room capacity is adjusted to maintain social distancing rules set by the government and hand sanitizer stations are provided in each of the meeting spaces and common areas. Food and beverage offerings throughout the day will be displayed in individual servings. The desk, work area, and equipment used will be disinfected directly after each meeting or event.

[Click here](#) to read about our 'Safe Stay' measurements, including implemented changes at every step of the guest journey. We are committed to ensure that you and your guests are able to meet in a safe environment. All standards will continue to be reviewed and re-evaluated regularly to ensure their relevance, and to ensure they are based on the guidance of the World Health Organisation and local health and government authorities.

More than ever, our team is ready to capture your hearts and minds as you explore and re-engage with us in the cultural, luxury heart of Amsterdam.

Capacity Chart

Name of room	Theatre style	Classroom style	Cabaret	Reception	Board room	Double boardroom	Triple boardroom	Diagonal boardroom (no screen)	U-shape	Double u-shape	Dinner	Area (sqm/sqft)	Floor (l x w x h) (m/ft)
Symphony Room	24	16	-	-	9	18	27	12	12	18	27	120sqm / 1291.67sqft	10 x 12 x 4.7m / 32.81 x 39.37 x 15.42ft
Harmony Room	9	-	-	-	9	-	-	-	-	-	9	36sqm / 388.50sqft	9 x 4 x 2.6m / 29.53 x 13.12 x 8.53ft
Blue Room	-	-	-	-	9	-	-	-	-	-	9	50sqm / 538.20sqft	10 x 5 x 2.7m / 32.81 x 16.40 x 8.86ft
Yellow Room	-	-	-	-	3	-	-	-	-	-	3	20sqm / 215.28sqft	4 x 5 x 2.7m / 13.12 x 16.40ft x 8.86ft
Red Room	-	-	-	-	4	-	-	-	-	-	4	20sqm / 215.28sqft	4 x 5 x 2.7m / 13.12 x 16.40 x 8.86ft
Orange Room	-	-	-	-	3	-	-	-	-	-	3	16sqm / 172.22sqft	4 x 4 x 2.7m / 13.12 x 13.12 x 8.86ft
Taiko Cuisine	-	-	-	-	-	-	-	-	-	-	28	110sqm / 1184.03sqft	-
Taiko Bar	-	-	-	-	-	-	-	-	-	-	-	99sqm / 1065.62 sqf	18 x 5.5m / 59.06 x 18.05ft

SECOND FLOOR

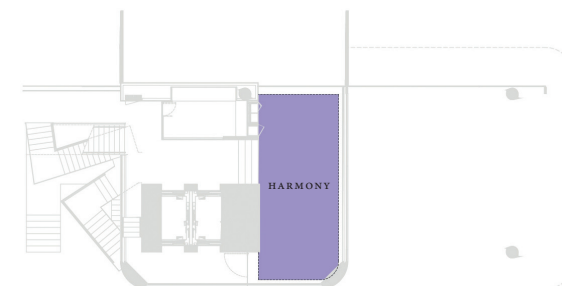

THIRD FLOOR

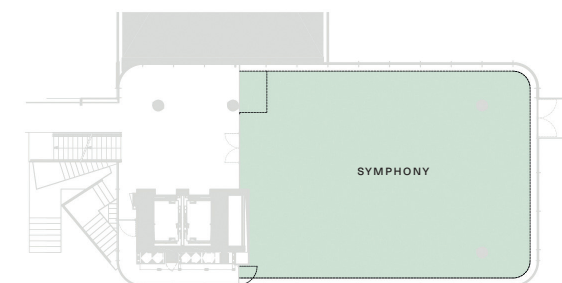

FIFTH FLOOR

